



# Ocean 43

*Centre cockpit cruising at its best*





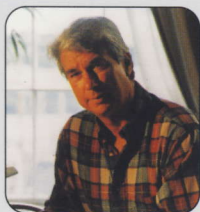

*"The Ocean 43 is genuinely a boat for the future, combining the best of new technology with all the traditional values of the past"*

Ron Holland

The totally new Ocean 43 is a centre cockpit blue-water cruising boat created through the inspired collaboration between Westerly and leading superyacht designer, Ron Holland.

# 43

Westerly's traditional values of craftsmanship and luxury remain. But the addition of Ron Holland's skill in designing fast yet sea-kindly yachts, and the use of the most advanced construction techniques, has led to the creation of a remarkable yacht that represents a true revolution in design and execution. This stylish ocean-going yacht fills a gap between the popular

Oceanlord 41 and the flagship Ocean 49, allowing the luxury of the 43 to be more widely enjoyed. Designed for long voyages and comfortable family cruising, the intelligently simple design of her sail-handling systems means the Ocean 43 is still easily managed by a crew of two or even single-handed. Excellent sailing performance is complemented by spacious

accommodation normally associated only with larger yachts. For safe long distance ocean passages, the Ocean 43 is not only a remarkable Westerly, but is a yacht that offers features unrivalled by any other builder.







In addition to a large saloon there is a well-equipped galley and an exceptional navigation station. The aft owner's cabin has a centre-line, walk-around double berth and roomy en-suite facilities with separate shower stall.

Forward there is a further double cabin for guests, again with its own separate head and shower.

There is also an optional third sleeping cabin available with one or two comfortable sea berths.

This can alternatively be fitted as a workshop or laundry room.

Within these outlines, to personalise each boat, owners can choose from a number of options, selecting their own preference for berths, stowage facilities, choice of fabrics and wood finish – and even rigs, there is even an option available for alternative sail plan configurations.





## Ocean 43 – Key Features

### Hull

Technically advanced 'SCRIMP' constructed hull is not only environmentally friendly but provides an air free laminate of exceptional strength and stiffness. Impact resistance is superb and insulation properties are exceptional. As a result of this superior composite laminate and the exclusive use of vinylester resin Osmosis resistance becomes a by-product of this advanced technology.

### Keel

A computer designed lead keel fixed with massive stainless steel bolts concentrates the weight where it is needed, providing a stiff yet easily driven yacht.

### Transom

A bathing platform and fold down boarding ladder make swimming easy and are essential safety features.

### Cockpit

The deep centre cockpit gives an excellent position of command under power or sail. The mainsheet is well out of the way, safely situated behind the helmsman and the powerful self tailing winches are all easily at hand. The cockpit is finished with teak seats and cockpit grating.

### Deck

As with all the larger Westerlys teak side-decks in individual 10mm swept laid planks reflect the build quality, and an abundance of handrails and wide uncluttered decks allow safe movement about the boat. Features include a double offset anchor roller enables two anchors to be ready for action, while an electric anchor windlass takes away the effort.

### Specifications

Ocean 43		
Length overall	43'6"	13.25 m
Length waterline	35'11"	10.95 m
Beam	13'9"	4.2 m
Draft	5'9"	1.8 m
Mast height (above waterline)	64'0"	19.5 m
Displacement	29,767 lb	13,500 kg
Ballast	12,123 lb	5,500 kg
Engine	50 hp diesel	

### Sail areas

Fully Battened Mainsail	557 sq ft	51.76 m
Furling Genoa	467 sq ft	43.4 m

### Sails

A small foretriangle and a direct lead to the self tailing sheet winches make the furling genoa remarkably easy to tack. A fully battened mainsail with single line slab reefing is standard with the option of an in-mast furling system for even simpler short handed cruising.

### Instruments

As well as the standard compass, echo sounder and log, there is plenty of room at the chart table or in the instrument pod above the hatch for your individual choice of extra electronics.

### Electrical System

Three low maintenance batteries provide ample power through a changeover isolator for engine starting and domestic needs. A comprehensive switch panel is protected by circuit breakers and includes battery monitoring gauges. Interior lighting is by a combination of overhead and reading lights. As well as a full set of navigation lights there is even a deck floodlight fitted as standard. There is also a 240 volt ring main protected by residual current breakers to give you the convenience of AC power while the built in battery charger looks after your batteries and the immersion heater warms the water when you don't want to run the motor.

### Engine

The large walk in engine room gives easy access to the 50hp diesel and a larger 65hp unit is available for those who require the extra power. The well lit engine room is fully sound deadened and has space for an optional diesel generator. Both fuel and water capacities are designed for serious living board.

### Water System

Pressurised hot and cold water are standard at the galley and in both heads compartments where there are wash basins moulded into the granite effect worktops. Each en-suite heads compartment has its own pump out shower including a separate shower stall aft.

### Accommodation

The forward guest cabin features a domestic size double berth, dressing table, generous stowage and an en-suite shower and toilet. The optional wing cabin is ideal for children. The spacious saloon has wrap around seating with an adjustable table. The owners suite aft is huge with a walk-around centre-line double bed surrounded by extensive stowage for all manner of personal gear plus a dressing table.

### Interior

All woodwork is in a choice of oak or teak and there is a wide range of complementary soft furnishings. The deckhead panels are easily removable for access to wiring and services and the floorboards are made of a special teak and holly striped laminate that needs no maintenance.

### Navigation Area

A large forward facing chart table has its own separate seat, deep stowage for charts, space for extra electronics and stowage for books. A VHF radio even comes as standard.

### Galley

A gimballed three burner cooker with grill and oven is surrounded by a superb granite effect worktop with double moulded sinks. The huge refrigerated icebox can be split into a fridge/freezer at extra cost and with a second inboard work surface over yet more cupboards, cordon bleu entertaining is simple.

### General Equipment

As you would expect from a Westerly the standard equipment package includes items such as anchor and chain, warps, fenders, bilge pumps, emergency tiller, fire extinguisher, gas bottle, opening stern rail, ensign socket, harness points in the cockpit, signal halyards, sailcover and a comprehensive owners manual. Your yacht is even delivered antifouled and ready for launching straight off the lorry.

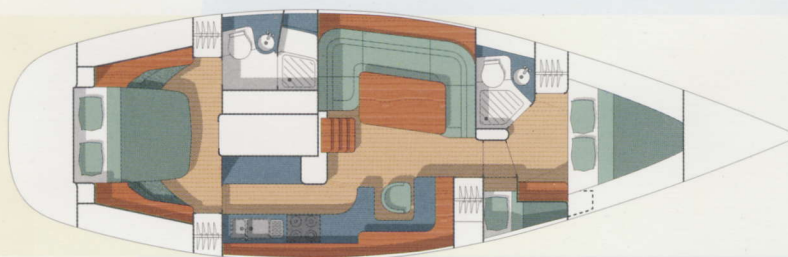
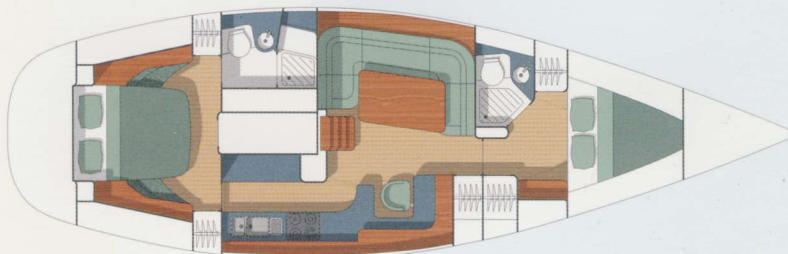



There is something about a Westerly that is hard to define, but the familiar appearance of the Ocean 43 confirms the integrity of workmanship and the quality values that belong to all Westerly yachts. With a small foretriangle and a powerful main, the Ocean 43 offers an easy-tacking furling headsail to make short-handed sailing a breeze.



### Construction

The Ocean 43 is built using the 'SCRIMP' process, successfully pioneered in Europe by the Westerly Group's composite division and well proven in the defence and aeronautical industries. In this, resin is applied to the hull mould under vacuum, which ensures even cover and total penetration, increasing strength and so providing a guaranteed construction standard for a minimum weight. The process is immensely environmentally friendly. It uses, and wastes, less materials, and with lamination and curing taking place in a vacuum, emissions are kept to an absolute minimum. The use of vinylester resin in the laminate provides osmosis resistance.



### Brokerage

Our in-house team has unique experience in the value of used Westerlys'. They can confirm the exceptional residual values of any Westerly. Don't hesitate to contact them for help or advice on the Westerly of your choice.

### Quality

Westerly's Production Manager oversees every aspect of design and construction, ensuring that every facet of each boat meets the company's own stringent standards, besides meeting all the highest internationally recognised quality standards including ISO 9001 and EN 29001. Each new Westerly yacht is delivered with the significant benefit of being CE and RCD compliant.

### Support

As a Westerly owner you will also benefit from the continuing support and advice of the yard and the world-wide network of dealers. From insurance to maintenance and repairs and the supply of spare parts or accessories, you are guaranteed all the help you might need for as long as you sail a Westerly. There is also a very active Westerly Owners' Association which offers a range of events, services and discounts to its many thousands of members.





## Your Westerly

Each new Westerly is built to your individual requirements and our team of highly experienced sales and production experts will be delighted to discuss details of specification changes you may wish to make. If you have a yacht to trade in, you may rest assured that our expertise and guidance on value is backed by years of experience. Why not call us now for further information and join the discerning breed of owners who will truly agree, the purchase of their Westerly Yacht was **'one of life's better decisions'**.



The standard inventory of some models may change. Please refer to the current specification sheet. Pictures within this brochure may show a boat fitted with optional extras.

Call us for more information,  
or to arrange a test sail.

**Telephone +44 (0)1703 455233**



# WESTERLY

Westerly Group Limited  
Hamble Point Marina  
School Lane  
Hamble  
Southampton SO31 4NB  
Telephone + 44 (0)1703 455233  
Facsimile + 44 (0)1703 455999  
e-mail: [westerly@btconnect.com](mailto:westerly@btconnect.com)

*A member of the Marigot Group*

The Westerly range of yachts  
spans 33ft to 49ft

Designed and produced by Marketing Matters Limited.  
Reprinted in England 8.98.