

Westerly Marine

W34

LOA	34.0 ft.	10.36 m.
LWL	28.5 ft.	8.69 m.
Beam	11.5 ft.	3.51 m.
Draft (Twin keel)	4.33 ft.	1.32 m.
Designed Displacement	15,571 lbs	7077 Kg

Sail Areas

Mainsail	242 sq. ft.	22.49 sq. m.
Light weather genoa	486 sq. ft.	45.15 sq. m.
No. 1 Genoa	451 sq. ft.	42 sq. m.
No. 2 Genoa	398 sq. ft.	37 sq. m.
No. 1 Jib	248 sq. ft.	26.35 sq. m.
No. 2 Jib	182 sq. ft.	16.9 sq. m.
No. 3 Jib	95 sq. ft.	8.8 sq. m.
Spinnaker	1113 sq. ft.	103.40 sq. m.

Lloyds Hull Construction Certificate

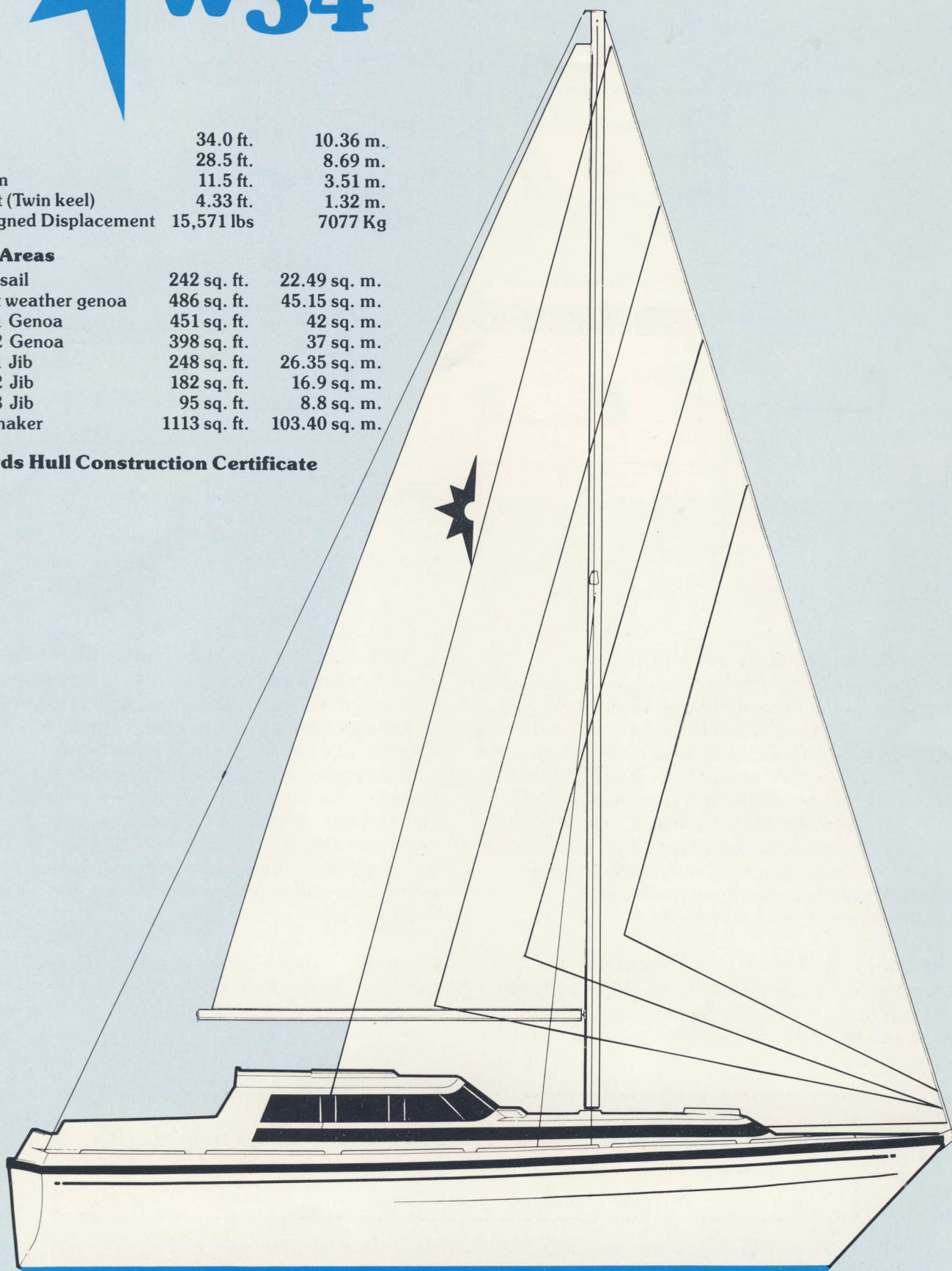

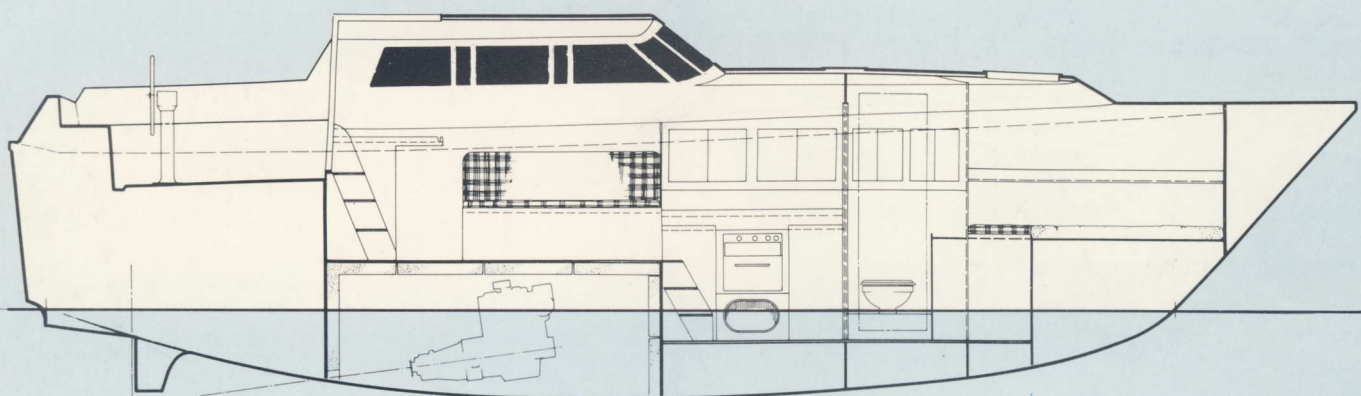
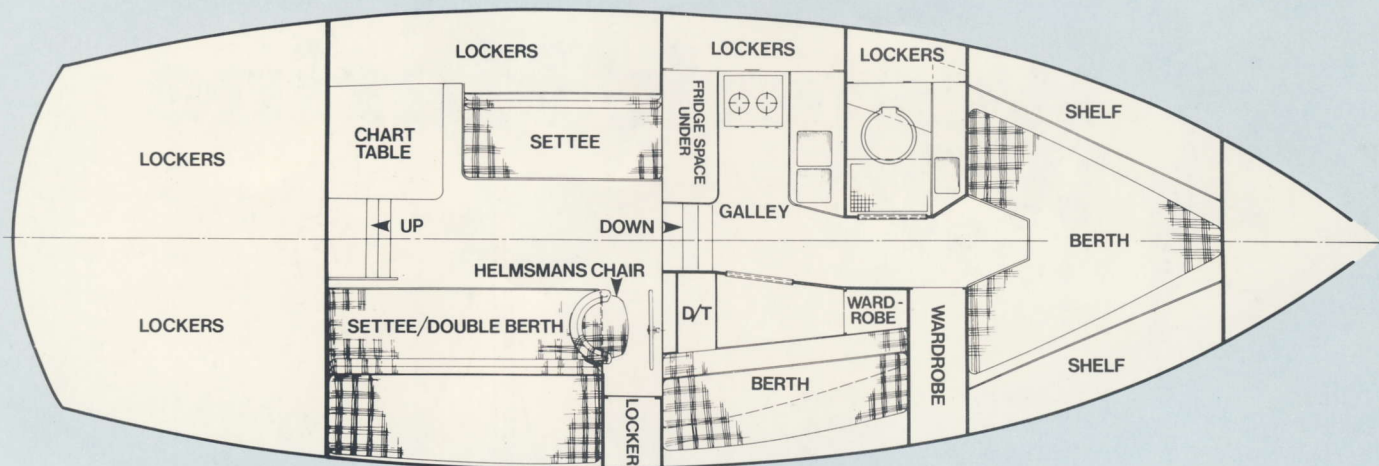

Westerly Marine and Laurent Giles have designed and built the Company's latest model, a new 34 foot sailing cruiser with a pilothouse deck. The designer's brief was to produce a boat which would sail properly as well as motor, and from the attractive hull shape, it will be seen that the boat can fulfil both functions equally well. The pilothouse yacht has a very full standard inventory, including a powerful diesel inboard engine, working sails, internal and external steering positions and a full complement of deck hardware.

The boat with its spacious, functional, cockpit, is designed for comfortable cruising. It has an attractive light and airy deck saloon with good all round visibility. Here there is a double berth

to starboard incorporating the helmsman's seat, while to port there is a chart table and settee. Forward of this on lower level, is a spacious modern galley to port, opposite which is a comfortable separate cabin. The heads compartment with marine WC and fresh water shower is located to port and the forecabin has the traditional 'V' berth arrangement. A door separates this from the rest of the boat. There is an abundance of stowage lockers in all cabins with full length hanging wardrobes conveniently located.

Westerly's new 34-footer is an ideal long distance cruiser and one that can be lived aboard and sailed in considerable comfort.



WESTERLY MARINE CONSTRUCTION LIMITED

Aysgarth Road · Waterlooville · Portsmouth PO7 7UF · England

Telephone: Waterlooville (07014) 54511 Telex: 86328

