

*You'll find very few yachts that will outclass this remarkable new Regatta 310 from Westerly. For this is a boat that will reward her crew with outstanding performance and a responsive feel that's both predictable and stable. Her deck and cockpit layouts are extremely well thought out, not just for the demands of racing, but for cruising shorthanded too, so every fitting, from the solid teak coachroof grab rails to the stainless steel guardrails and stanchions, is of the very highest quality and strength.*

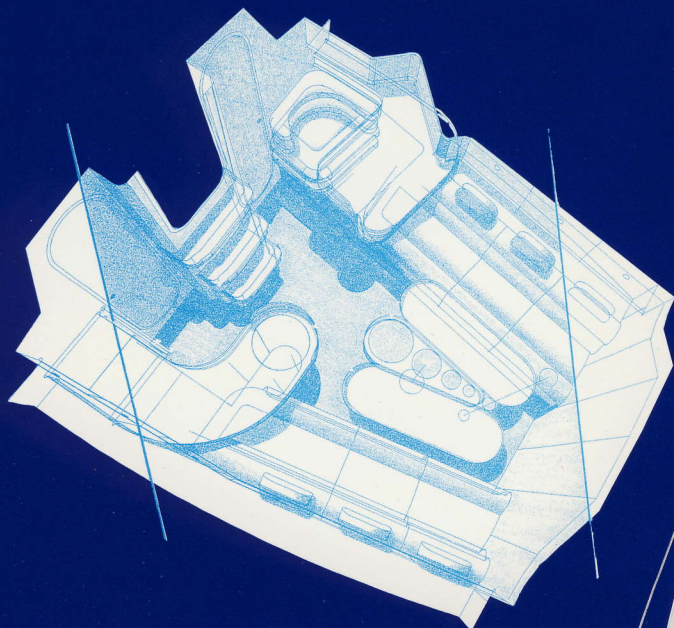

*The mid-range Regatta, the 310 has a tremendous feeling of space and comfort, further enhanced by the low seat backs in the saloon, with their unique, individual headrests. These open out the view to the ship's sides, and high lockers above run the full length of the saloon, so plenty of secure storage is still a feature of this attractive area.*

*The well equipped and spacious galley area, opposite the navigation station, is a good example of just how successfully we have been able to blend the practical needs of the racing scene with the more leisurely and stylish cruising lifestyle.*

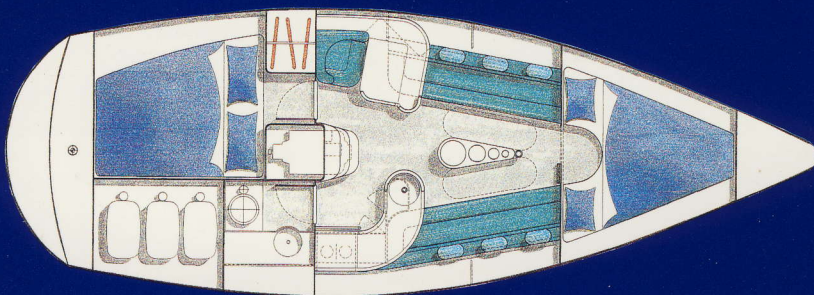

SAIL AREAS			DESIGNED WEIGHTS			SPECIFICATIONS		
Mainsail	242ft <sup>2</sup>	22.48m <sup>2</sup>	Displacement	9020lb	4100kg	Length Overall	30'4"	9.32m
No.1 Genoa	291ft <sup>2</sup>	27.05m <sup>2</sup>	Ballast - Fin - Twin	2690lb	1220kg	Length Waterline	24'6"	7.47m
No.2 Genoa	238ft <sup>2</sup>	22.14m <sup>2</sup>		2866lb	1300kg	Beam	10'10 1/2"	3.32m
No.1 Jib	187ft <sup>2</sup>	17.45m <sup>2</sup>				Draft - Fin	5'0"	1.53m
Storm Jib	60ft <sup>2</sup>	5.57m <sup>2</sup>				- Twin	3'9"	1.15m
Spinnaker	615ft <sup>2</sup>	57.12m <sup>2</sup>				Mast Height Above Waterline:	45'11"	14.0m