

WESTERLY 33

Produced by Westerly Marine — Designed by Laurent Giles & Partners

Sail areas — ketch rig

Mainsail	186 sq ft	17.3 sq m
Mizzen	69 sq ft	6.4 sq m
Genoa	380 sq ft	35.3 sq m
No. 1 Jib	255 sq ft	23.7 sq m
No. 2 Jib	182 sq ft	16.9 sq m
No. 3 Jib	95sq ft	8.8 sq m

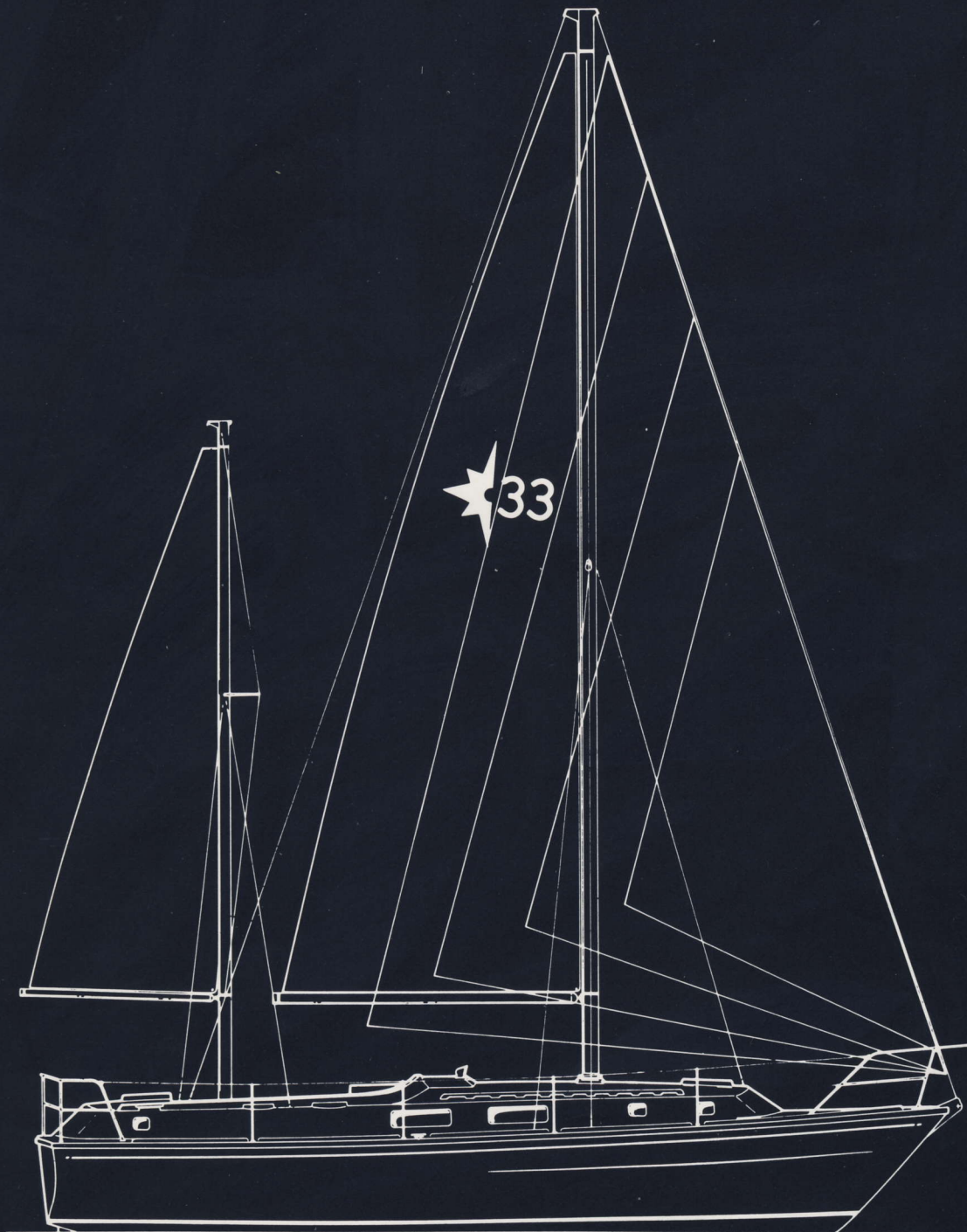

WESTERLY MARINE CONSTRUCTION LIMITED

Aysgarth Road . Waterloooville . Portsmouth PO7 7UF . England

Telephone: Waterloooville (070 14) 54511.

Telex 86328.



Q.A.
1969
1970
1977

WESTERLY 33

Westerly 33 is a fin keel, centre cockpit, sailing cruiser similar in design to Conway. Being responsive and easy to handle she is a true family boat with the ability to cruise offshore and, for the more venturesome, is ideal for long sea passages. Westerly 33 is supplied in a sailaway condition and a 35 hp four cylinder diesel is fitted as standard. There is a choice between sloop or ketch rig.

The accommodation in the one standard layout is in three cabins. This provides seven berths with full standing headroom in the saloon and forward cabin. A feature of this boat is that the interior is built entirely of wood giving a very warm, attractive appearance. It also has the advantage of allowing the owner plenty of scope for fitting personal gear. The lockers under the side decks and in the aft cabin are wood-lined to give dry stowage. A generous amount of space has been allowed for the galley and chart areas and a double berth in the saloon is fitted as standard.

On deck the long low coachroof and wide side decks contribute to the safety of the crew and two very large, deep cockpit lockers provide ample stowage for all sails and sailing gear.

Construction is extremely robust with heavy reinforcement at key points in the GRP hull and deck. Precise, solid workmanship with top quality materials and fittings are characteristic of all Westerlys and, like

the rest of the range, Westerly 33 is issued with an individual Lloyd's Register Certificate. Particular care is taken to maintain a high standard of construction and finish and a quality controller is constantly involved in checking each boat throughout building.

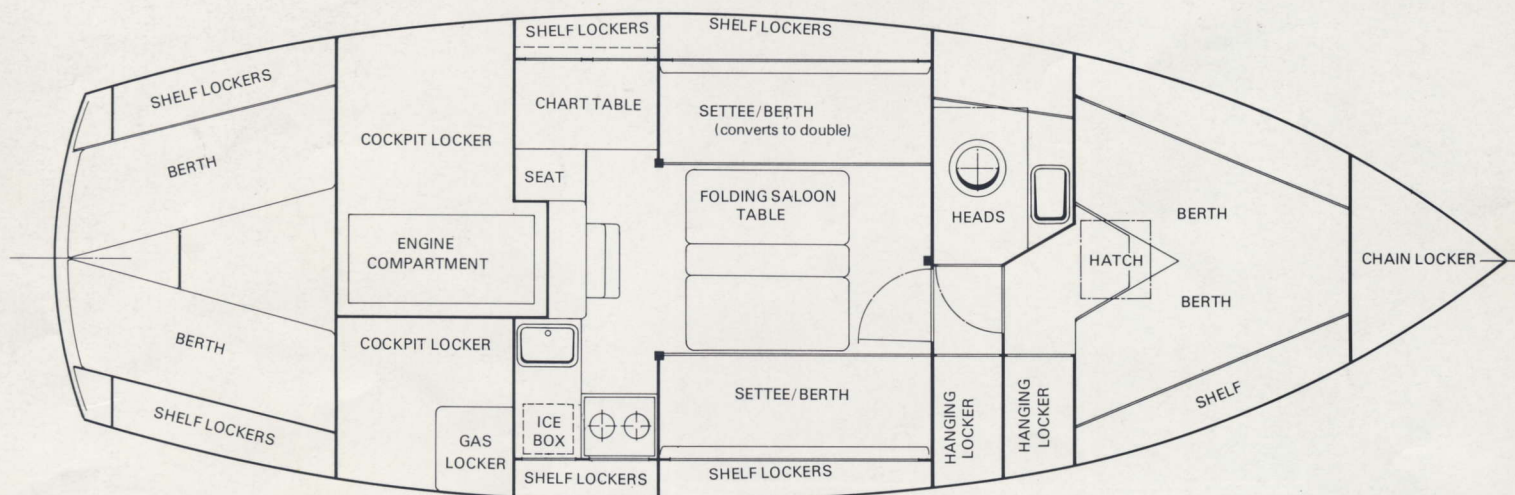

SPECIFICATION

Length overall	33.25ft	10.14m
Length waterline	28.43ft	8.66m
Beam	11.17ft	3.4m
Draft	5.46ft	1.66m
Displacement	6.74 tons	6505kg
Ballast	2.7 tons	2743kg

Rigging-standing	1 x 19 7mm stainless steel, swaged ends (main mast) 1 x 19 5mm stainless steel, swaged ends (mizzen).
------------------	---

Rigging-running	main and jib sheets, 1.5in. plaited terylene halliards.
-----------------	---

Jib sheet winches-	top action, two speed.
--------------------	------------------------

Masts and spars-

gold anodised aluminium alloy through mast reefing main mast.

Mast lengths-

Ketch main 38.5ft 11.74m.
Mizzen 24.75ft 7.54m.

Seacocks & skin fittings-

gun metal.

Deckfittings-

stainless steel or alloy, through bolted.

Steering-

wheel steering, cable system though sheaves to quadrant.

Rudder-

stainless steel assembly, self-lubricating plastic bushes and solid fibreglass blade, with stainless steel plate insert. An emergency tiller is provided.

Woodwork-

all deck fittings of teak, all interior fittings of teak and sapele.

Engine-

Thorncroft 90 35h.p. flexibly mounted, alternator, water cooled exhaust, reverse gear and electric start.

Battery-

2 batteries as standard, total capacity 104 a h at 12 volts.